

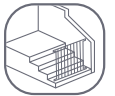

Your way to a safer home

pressure fit clear-view & wooden stairgates

Instructions for use



Fits bottom
stairs **only**



Fits inside
opening



76-96cm wide
(30-37.8")*
*124cm (48.8") with
additional Gate Extensions

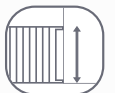

77cm high
(30")



Fits over
skirting up to
5cm (2") wide



**Screw or
adhesive mount**
for brick or wooden walls

0-24
Months

Version 1, for gates where product codes begin with FRPA & FRPW

Step by step video fitting guides at
www.fredsafety.co.uk



Exceeds
safety standards

IMPORTANT! READ AND FOLLOW THESE INSTRUCTIONS CAREFULLY AND KEEP FOR FUTURE REFERENCE

Please read the instructions thoroughly, failure to do so may result in damage to the gate or could in worst case cause injury to your child. When unpacking the gate, carefully check all parts but **do not release the cable tie holding the gate closed until step 13.**

Safety Warnings

- This gate is designed and tested for children up to 24 months. However, this guidance should be constantly monitored against your child's own development. Individual children's skills develop at different ages and if your child can operate or climb the gate, it should not be used.
- **WARNING** - Incorrect installation can be dangerous.
- **WARNING** - Do not use the safety barrier if any components are damaged or missing.
- **WARNING** - The safety barrier must not be fitted across windows.
- **WARNING** - Never use without wall cups.
- Ensure that the wall, door frame or stairpost to which you are fitting the gate, is strong, rigid and free of dirt and grease.
- If the surface to which you are fixing your gate is not completely flat and vertical, fingertraps may be formed between the wall and the gate. Please use additional spacers when fitting the gate to eliminate them.

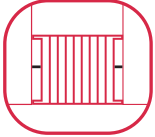

- Ensure the gate including any Extensions is centred within the opening and the gap between the gate and the opening is **more than 3cm and less than 5.8cm wide**.
- For your child's safety, it is essential that a safety barrier is positioned correctly in relation to the stairs.

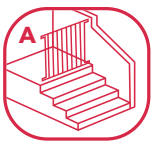

- To prevent the child from falling down the stairs, if the safety barrier is used at the top of the stairs, it should not be positioned below the top level, **fig. A**.

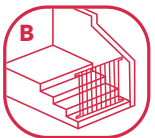

- To prevent the child from climbing the stairs, if the safety barrier is used at the bottom of the stairs, it should be positioned at the front of the lowest tread possible, **fig. B**.
- Keep these instructions and the tools provided for future reference and use.
- Once the gate is installed, read the instructions again and check the gate is correctly fitted and secure.

Product information

- Fits openings from **76-96cm** (30-37.8") with the fittings supplied. Additional Gate Extension Kits are available to fit openings up to **124cm** (48.8").
- This gate is for domestic indoor use only.
- This gate has a manual locking mechanism with a slam-shut function.
- When fitted as per these instructions, this safety gate conforms to: **EN1930:2011**.

Everyday use

- Please note that this product will not necessarily prevent accidents from happening. Never leave your child unattended.
- Always check that the gate is correctly closed after passing through.
- Always keep the gate in a closed and locked position.
- Do not hang or tie toys to any part of this gate.
- Your gate only opens through 105°. Pushing/forcing it to open further can damage the hinges such that the gate no longer provides an effective safety barrier.
- Never allow your children to play or swing on the gate.
- Do not allow children, animals or adults to climb over the gate. They may fall and injure themselves, or damage the gate so that it can no longer provide an effective safety barrier.
- If the gate is damaged, or has been exposed to a large impact, it must not be used again.

On-going checks

- Regularly check the gate to ensure that it is secure and functioning in accordance with these instructions.
- If additional or replacement parts are needed, only use those obtained through the manufacturer. Enquire online through www.fredsafety.co.uk

Other important information

Uncompromising on safety, only high performance materials are used in the manufacture of the Fred® range. The Wooden Gate is engineered from top quality Poplar taken from well managed, sustainable forests, and the Clear-View gate from Acrylic. The fittings are zinc plated steel together with top quality PA6, POM and PP plastics.

- **Guarantee:** Your Fred® Gate is guaranteed to be free from manufacturing defects for a period of 1 year from date of purchase under normal use and in compliance with these instructions. The guarantee extends only to the original retail purchaser and proof of purchase is required.
- **Product registration:** Please register your purchase at www.fredsafety.co.uk/register. By registering, we guarantee to contact you in the unlikely event that a safety notification is required. You can extend your guarantee for a further 3 months free of charge by registering your gate on our website.
- **Care instructions:** Wipe with a soft, damp cloth. Do not immerse in water. Scratches and other surface damage is not covered by guarantee and should be avoided e.g. don't knock your gate with sharp or hard objects and train pets to keep away.

Positioning your gate

This Pressure Fit Gate is only intended to be used in doorways, at the bottom of the stairs or as a room divider when installed between two strong and rigid surfaces. A pressure gate pushes hard into the wall. To avoid damage to plasterboard walls, ensure Wall Cups are positioned where there is a wall stud behind the plasterboard, or screw a batten to the wall between wall studs and position the Wall Cups against the batten.

Important! Never use a Pressure Fit Gate at the top of stairs, the bottom cross bar creates a tripping hazard.

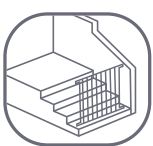

Fits bottom stairs only

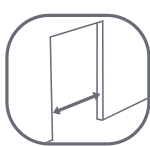

Fits inside opening

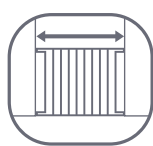

76-96cm wide (30-37.8")*

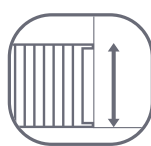

77cm high (30")

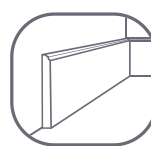

Fits over skirting up to 5cm (2") wide

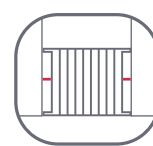

Centre gate min 3cm-max 5.8cm (1.2-2.3")



Do not fit at top of stairs

*Additional Gate Extensions are available to fit openings up to 124cm (48.8")

Before you start

1. Decide how to fit your Wall Cups

To provide an effective safety barrier, this gate **must** be used with Wall Cups which need to be firmly attached to a flat wall or door-frame. Fixtures and fittings are supplied to secure the Wall Cups either with adhesive or screws, and it is essential that the appropriate method is used. If in any doubt, please get expert help.

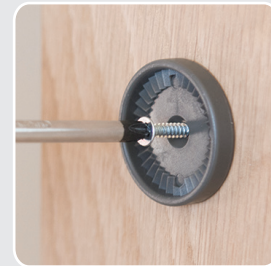

✓ Either Screw installation

- Any wall or opening, whether it be made of wood, brick or concrete and whatever the finish so long as it is strong, rigid and flat.



Drill



Philips Screwdriver



6mm Masonry or 2mm Wood Drill Bit

Important! Before drilling, check for hidden pipes and cables using a detector.

✓ Or Adhesive installation

- Clean, grease-free **wooden surfaces only**.



- On uneven surfaces.
- On surfaces with flaking paint or varnish.
- Any time you are unsure!**



Cloth



Water & White Vinegar/
Surgical Spirit

Caution! Fred ExtremeHold™ adhesive may cause damage to some surfaces. We accept no liability or responsibility for damage or defects arising from the use of the adhesive on any walls or surfaces.

Please resist the temptation to use adhesive on an inappropriate surface just because installation is quicker and easier. Your child's safety is more important.

2. For walls without a flat surface

If your wall does not have a flat surface to which Wall Cups can be attached, the following additional Fred® Accessories are available. For more information please visit www.fredsafety.co.uk

Fred® Universal Wall & Skirting Kit



Screws to your wall to provide a flat surface over skirting boards that are up to **22mm** (7/8") thick.

Fred® Stairgate Y-Spindle



Replaces the spindles supplied with this gate, and allows them to be fitted directly to stairposts up to **75mm** (3") diameter.

Fred® Universal Stairpost Fitting Kit



Straps directly to any shape of newel post or baluster to provide a flat surface against which any stairgate can be fitted.

Before you start continued

3. Check the width of your opening

Measure the width of your opening to calculate the number of Gate Extensions needed. Each Fred® Pressure Gate and Gate Extension Kit includes both a long and a short gate extension to fit either side of the gate.

Size of Opening	Extensions Required	Additional Accessory Required	Position of Gate Extension(s)
76-82cm (30-32.3")	None	n/a	n/a
82-89cm (32.3-35")	1	Included with Gate	1 on one side
89-96cm (35-37.8")	2	Included with Gate	1 on each side
96-103cm (37.8-40.6")	3	One Gate Extension Kit	2 on one side and 1 on the other
103-110cm (40.6-43.3")	4	One Gate Extension Kit	2 on each side
110-117cm (43.3-46")	5	Two Gate Extension Kits	2 on one side and 3 on the other
117-124cm (46-48.8")	6	Two Gate Extension Kits	3 on each side

What's included

Parts List Page 1



(A) 1 x Pressure Fit Gate

What's included



(B) 1 x AccuFit™ Spindle Housing & 1 x Spindle Housing



(C) 1 x Short Gate Extension



(D) 1 x Long Gate Extension



(E) 2 x Top Spindles with Tensioning Wheels



(F) 2 x Bottom Spindles with Nuts



(G) 4 x Wall Cups

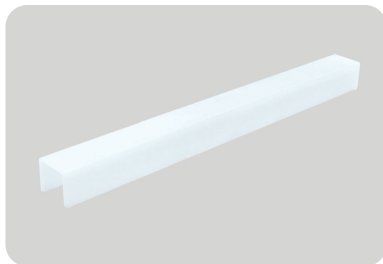

(H) 1 x Glow Strip



(I) 1 x Spanner



(J) 1 x Magnetic Spirit Level & Marker Tool

Marker Tool comes inserted within the Spirit Level



(K) 4 x Small Screws



(L) 4 x Large Screws & 4 x Wall Plugs

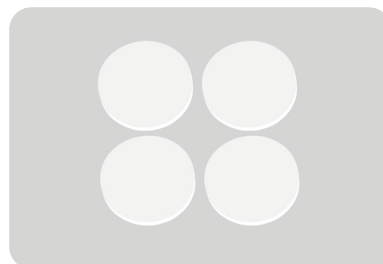

(M) 4 x Adhesive Pads



(N) 2 x Allen Key



(O) 1 x Left One-Way Stopper & 1 x Right One-Way Stopper

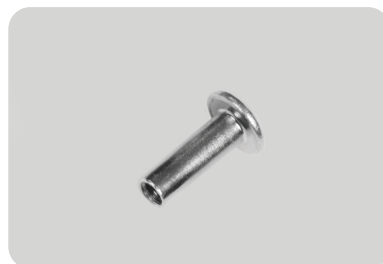

(P) 1 x Long Barrel Nut

Parts List Continued

Step by step installation guide



Slide the Spindle Housings (B) into the bottom bar of the Gate (A). The AccuFit™ Spindle Housing (with the red flash) slides into the **locking** side of the Gate, and the other Spindle Housings into the hinge side and any Gate Extensions that are needed.



If you need to use Extensions ([see page 4](#)), slide them into the holes on the side of the Gate. The Short Gate Extension (C) fits into the hinge side of the Gate, and the Long Gate Extension (D) into the locking side. The single metal prong slides into the lower of the 2 holes found at the top of the Gate.



Spin the Tensioning Wheels of the Top Spindles (E) until the smooth side (without the 4 small pins) rests against the head of the Spindle. Slide them into the upper of the 2 holes at the top of the Gate (or Gate Extension if used).



Spin the Nuts of the Bottom Spindles (F) until they rest against the head of the Spindle. Slide one into each of the Spindle Housings found at the base of the Gate.



Click the Wall Cups (G) onto the ends of the Top and Bottom Spindles.



Slide the Glow Strip (H) onto the bottom rail of the Gate.

Option A: Screw Installation of Wall Cups



Laying the Gate across the opening, so that the 2 bottom Wall Cups are in contact with the floor, tighten the Nuts on the Bottom Spindles (using the Spanner (I) if necessary) until there is enough pressure for the 3 small pins on the Wall Cups to mark the wall.



Hold the Gate vertical, and position the Magnetic Spirit Level (J) onto the metal on first one, then the other side of the Gate. Ensure that the bubble inside the Magnetic Spirit Level is centred and the Gate is completely vertical, before moving on to **Step 9A**.



Tighten the Tensioning Wheels of the Top Spindles to push the Wall Cups towards the wall. Keep turning until there is enough pressure for the 3 small pins on the Wall Cups to mark the wall. Once confident the marks will be visible, undo the Tensioning Wheels and Nuts of the Spindles to remove the Gate and unclip the Wall Cups from the Spindle heads.



Take the Marker Tool (J) out of the Magnetic Spirit Level and mark the central, drilling point between the 3 small marks made by each of the 4 Wall Cups. Drill the holes.

10 A Continued

1. When attaching to wood:

Drill **2mm** pilot holes, and use the Small Screws (K) provided to fix the Wall Cups to the wall.

2. When attaching to plastered or un-plastered concrete/brick:

Use a size **6mm** drill bit to drill holes, fill each one with a Wall Plug (L) then use the Large Screws (L) to fit the Wall Cups to the wall.

3. When attaching to stud walls or other thin partitions:

Ensure that you screw into a stud behind the plasterwork and use an appropriate fixing system to attach the Wall Cups to the wall. Get expert help if in any doubt.



Release the Tensioning Wheels and Nuts on the Spindles until you can hold the Gate back into position between the Wall Cups. Re-tighten the Nuts and Tensioning Wheels alternately to push the Spindle heads firmly into the Wall Cups. **Skip down to Step 12.**

Option B: Adhesive Installation of Wall Cups to Wood



Fred ExtremeHold™ Adhesive is instantly strong. It cannot be repositioned when placed incorrectly so test **steps 9-11** first, without exposing the adhesive. Clean and thoroughly dry the flat side of each of the Wall Cups, and the sections of your wall/door frame where the Wall Cups will attach with a 50:50 solution of water plus either white vinegar or surgical spirit.



Ensuring that the Spindles are still fully inserted into the side of the Gate, and with the Wall Cups clipped onto the Spindle head, remove the protective layer on one side of each of the Adhesive Pads (M) and press firmly onto the flat side of each Wall Cup for 30 seconds.



Laying the Gate across the opening, so that the 2 bottom Wall Cups are in contact with the floor, remove the protective layer on the 2 **lower** Adhesive Pads then tighten the Nuts on the Bottom Spindles so that they push the Wall Cups firmly onto the wall, using the Spanner (I) if necessary.



Hold the Gate vertical, and position the Magnetic Spirit Level (J) onto the metal on first one, then the other side of the Gate. Ensure that the bubble inside the Magnetic Spirit Level is centred and the Gate is vertical, before moving on to Step **11B**.



Remove the protective layer on the upper Adhesive Pads, then tighten the Tensioning Wheels of the Top Spindles to push the Wall Cups firmly onto the wall.

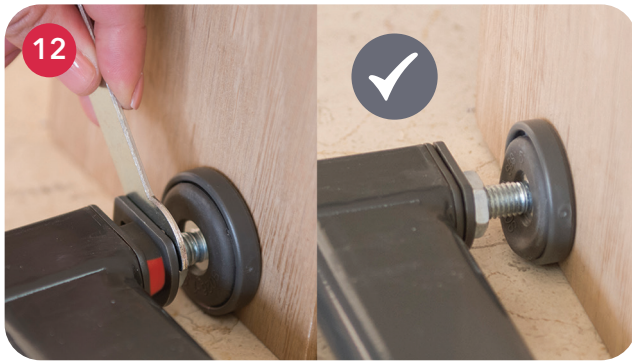

Use the Spanner (I) to tighten the Nuts on alternate sides of the Gate until you can no longer see red on the Accu-Fit™ Spindle Housing. Both Nuts should be tightened equally, so that the Gate is centred and an equal amount of the Spindle remains exposed on each side.

IMPORTANT: For the safety of your child:

- It is essential that the Gate, including any Extensions, is centred within the opening.
- Gaps between the edge of the Gate/ Extensions and the opening are **no less than 3cm and no more than 5.8cm.**
- The red mark on the AccuFit™ Spindle Housing is never visible when the Gate is in use.

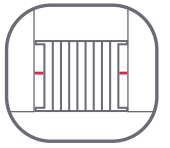

Centre gate
min 3cm-max
5.8cm (1.2-2.3")



Cut the cable tie, and keeping the Gate locked (with green visible in the window of handle), turn the Tensioning Wheels until the red stripe on the top of the handle just disappears.



Check the Gate opens and closes correctly; the indicator shows red when open, green when locked. If it does not operate correctly, check that the Gate is vertical and/or adjust the Tensioning Wheels.

Using the optional One-Way Stopper



Use the optional One-way Stopper if you want to open the Gate in one direction only. Use both Allen Keys (N) to remove the Barrel Nut and Screw on the handle that is closest to the opening edge. Choose either the left or right One-Way Stopper (O).



Position the One-way Stopper on the side of the Gate that **does** want to open. The small lip fits under the bottom of the handle and the curved end faces towards the side rail. Lining up the holes in the One-Way Stopper and the handle, use the Allen Keys to secure in place using the Screw and replacing the Short Barrel Nut with the Long Barrel Nut (P).

To open and close the gate

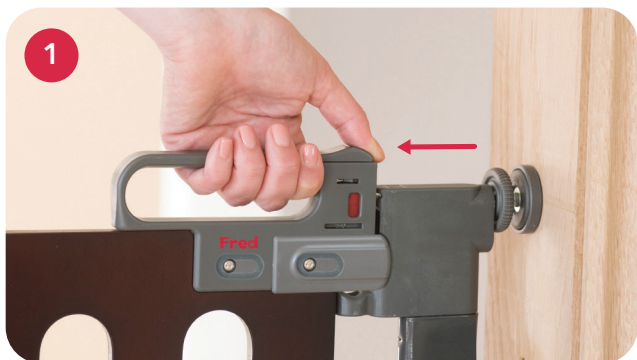

To open the Gate, holding the handle, use your thumb to slide the locking catch on the top of the Gate Panel back towards the handle, and simultaneously lift the Gate to swing it open. The window in the handle will show red when the Gate is open.

Important: Your gate only opens through 105°. Pushing/forcing it to open further can damage the hinges such that the gate no longer provides an effective safety barrier.

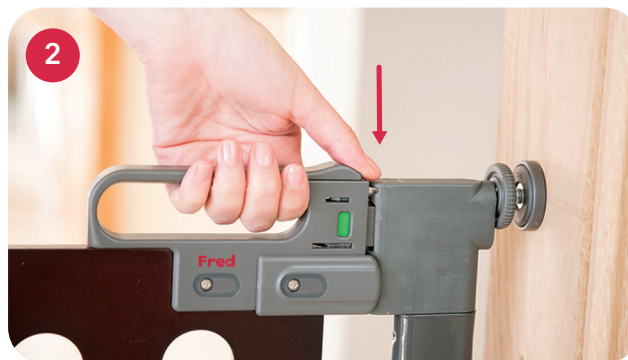

To close the Gate, lift the handle and lower it onto the locating pins of the catch rail. Alternatively, push the Gate and it will slam-shut automatically. The window in the handle will show green to indicate when the Gate is securely locked.

Important: The red line on the top, next to the locking catch, should **not** show when the Gate is locked. If it starts to show, readjust the width of the Gate (Steps 13-14).

Temporary removal



Undo the Tensioning Wheels and the Nuts, so that the Spindles come away from the Wall Nuts. The Gate can be removed leaving just the Wall Cups in position. To reinstall the Gate, follow the instructions from **Step 12** above.

Permanent removal



Remove the Gate as per the temporary removal. If the Wall Cups are fastened with Screws, simply unscrew them from the walls. If the Gate has been fitted with adhesive, use a blunt knife to carefully prise away the Wall Cups, and rub away any residual adhesive with your fingers.

For almost 60 years our family design team has made homes safer for children. Nothing beats parental supervision but accidents can happen; each and every clever little idea from Fred is designed to give you peace of mind. Safer by design and engineered using high performance materials, Fred products are fantastically quick and easy to install.

Carefully designed, top quality products for protecting against falls, finger-traps, electric shocks, burns and access to dangerous objects is what Fred is all about.

We can help you more at www.fredsafety.co.uk



Your way to a safer home

Making homes safer with Fred...



Screw Fit Wooden Gate



Screw Fit Clear-View Gate



Stove & Hob Guard



Door Slam Stopper



Plug Socket Cover



Invisible Magnet Lock



Multi-Purpose Block



Corner Protector



Fridge/Freezer Latch



We can help you more at
www.fredsafety.co.uk



FRPA & FRPW. Complies with EN1930:2011 and REACH.

Fred® is a registered trademark of its distributor Cheeky Rascals Ltd, Liss Mill, Mill Road, GU33 7BD, UK help@cheekyrascals.co.uk.

Design and manufacturing by Safe and Care Co. ApS, Sellerup Vangvej 32, DK-7080 Børkop, Denmark.

Danish Design. Patents Pending. Made in China.