

**0-24**  
Months

## universal wall & skirting kit

**Fred**<sup>®</sup>

Your way to a safer home

### FITTING INSTRUCTIONS

Uncompromising on safety, only high performance materials are used in the manufacture of the Fred range. This Wall & Skirting Kit is engineered from top quality Painted Pine, PP and Zinc plated screws.

#### Important!

Fred wants to keep you and your family safe but we need you to do your bit, please read and follow these instructions carefully. Once your product has been installed, please keep these instructions in a safe place for future reference.

Step by step video fitting guides at [www.fredsafety.co.uk](http://www.fredsafety.co.uk)

#### What's included:

- (A) 1 x Bottom Bar
- (B) 1 x Top Bar
- (C) 2 x Barrel Nuts & Bolts
- (D) 1 x Short Screw
- (E) 1 x Lower Spacer
- (F) 2 x Medium & 2 x Long Screws
- (G) 2 x Wall Plugs
- (H) 1 x Spirit Level & Marker Tool\*
- (I) 1 x Top Spacer
- (J) 3 x Additional Spacers
- (K) 1 x Spacer Cover

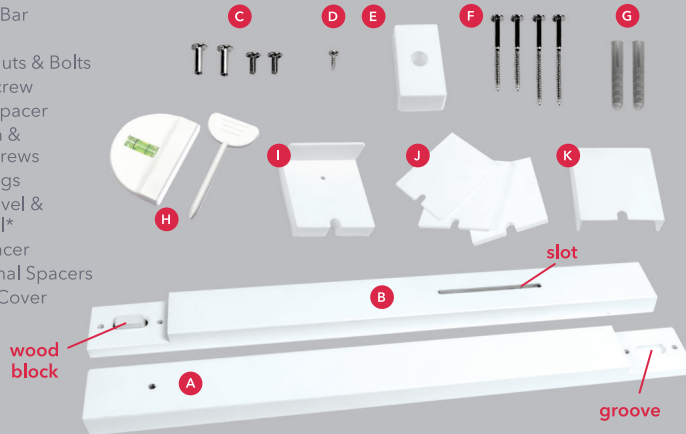

\*You will find the Marker Tool slotted inside the Spirit Level

### Recommended Usage

This kit provides a flat, vertical surface against which any safety gate can then be attached. It will fit over skirtings that are maximum **18.5cm (7.5")** high, **2.3cm (0.9")** wide, or to any height skirting into which you are able to drill. It will create a vertical surface against walls that tilt either into, or away from, the opening by +/- 1.5 degrees.

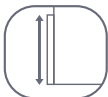

Creates a  
vertical surface



Fits over  
skirting max.  
**18.5cm**  
(7.5") high

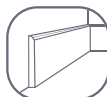

Fits over  
skirting max.  
**2.3cm (0.9")**  
wide

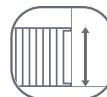

Fits Gates  
max. **86cm**  
(34") tall



Projects **4cm**  
(1.5") into  
opening

# Before you start

## 1. Check your opening

Check that your safety gate plus this kit will fit within the opening that needs protecting. This kit will reduce the width of your opening by up to **4cm (1.5")**.

## 2. Work out what your walls/sides of the opening are made of and gather your tools:

Only fit this Kit to walls or openings that are strong and rigid.



Drill



2mm Wood Bit or 6mm Masonry Bit



2 x Philips Screwdriver

### When attaching to wood:

Drill 2mm pilot holes at each of the 4 marked points and use the 2 Medium Screws (F).

### When attaching to plastered or unplastered concrete or brick walls:

Drill holes at the 4 marked points with a 6mm masonry bit and fill each with a Wall Plug (G). Use the 2 Long Screws (F).

### When attaching to stud walls or other thin partitions:

Ensure that you screw into a stud behind the plasterwork and use an appropriate fixing system (not supplied). Get expert help if in any doubt.

**Important! Before drilling, check for hidden pipes and cables using a detector.**

## Step by step installation guide

1



Assemble the Wooden Bars (A & B) by slotting the 2 halves together. The Wood Block of the Bottom Bar should slot into the groove in the Top Bar.

2



Secure together with the 2 Barrels Nuts and Bolts (C), using a screwdriver on either side to tighten them firmly. The back of the Wooden Bar is the side where the Bolts are **not** flush with the surface.

3



Position the Top Spacer (I) across the top of the Top Bar, and attach it to the back using the Small Screw (D). (If you are making a wall vertical that tilts towards the opening, this Top Spacer may not be needed).

4



Rest the Lower Spacer (E) on the top of the skirting. Remove the Marker Tool (H) from the Spirit Level and mark the drilling point by simultaneously passing it through the slot in the Wooden Bar and the Lower Spacer (if you are making a wall vertical that tilts away from the opening or directly to the skirting, this Lower Spacer may not be needed).

5



Drill a hole at the mark (see 'Before you start' section) filling the hole with a Wall Plug (G) if appropriate.

6



Reassemble the Wooden Bar plus Lower Spacer and loosely screw it against the wall - **do not tighten**.

7



Stick the Spirit Level (H) against the **side** of the Wooden Bar, ensure that it is vertical. Mark the position of the drill hole with the Marker Tool. Drill the hole as per '**Before you start**' and fill the hole with a Wall Plug (G) if appropriate.

8



Loosely screw the top of the Wooden Bar to the wall - **do not tighten**.

9



Place one Additional Spacer (J) into the Spacer Cover (K), and slide it down behind the top of the Wooden Bar until it rests against the Long Screw.

10



Using the Spirit Level against the **front** of the Wooden Bar, adjust the combination of the Spacers (J) until the Wooden Bar is vertical.

11



Tighten both of the Long Screws - you're now ready to mount your safety gate according to the fitting instructions.

## To remove



Unscrew each of the Screws from the wall and store in a safe place.

## Safety Warnings

- **WARNING!** Adult assembly required.
- **WARNING!** Incorrect installation can be dangerous.
- **ATTENTION!** This product acts as a deterrent but cannot replace adult supervision. Never leave children unattended. This is not a toy; do not allow children to play with it.
- Check the product regularly to ensure it is safe to use and working correctly. If worn or damaged, remove immediately and replace as needed.
- This product is designed to offer protection for children up to the age of approximately 24 months.
- If your child has learnt how to use a stairgate, stop using it immediately.

## Other Important Information

- **Care instructions.** Wipe with a damp cloth. Do not immerse this product in water.
- **Caution!** This product is designed to be strong and secure. We accept no liability or responsibility for damage or defects arising from the use of this kit on stair posts, walls, skirtings or any other surfaces.
- Claims against warranties or guarantees must be arranged through your retailer, seller or trader. Proof of original purchase is required.

Carefully designed, top quality products for protecting against falls, finger-traps, electric shocks, burns and access to dangerous objects are what Fred is all about.

We can help you more at [www.fredsafety.co.uk](http://www.fredsafety.co.uk)

FRWK. Complies with EN71-1 and REACH. Fred® is a registered trademark of its distributor Cheeky Rascals Ltd, Liss Mill, Mill Road, GU33 7BD, UK [help@cheekyrascals.co.uk](mailto:help@cheekyrascals.co.uk). Design and manufacturing by Safe and Care Co. ApS, Sallerup Vangvej 32, DK-7080 Børkop, Denmark. Registered Design. Made in China.



Making homes safer with Fred...



Universal Stairpost  
Fitting Kit



Screw Fit Wooden  
Gate



Pressure Fit Clear-View  
Gate



Stove & Hob Guard



Plug Socket Cover



Invisible Cupboard Lock



Multi-Purpose Block



Corner Protector



Double Door Block

We can help you more at  
[www.fredsafety.co.uk](http://www.fredsafety.co.uk)

