

6-24
Months

Fred[®]

Your way to a safer home

adhesive double door block

Instructions for use

Uncompromising on safety, only high performance materials are used in the manufacture of the Fred range. This Double Door Block is engineered from top quality ABS and POM.

What's included:

(A) 1 x Block (B) 1 x Top Fix Locking Tab
Central Partition Locking Tabs
(C) 1 x Small (D) 1 x Medium
(E) 1 x Large (F) 1 x Extra Large
(G) Mounting Plate
(H) EZ-Dock™



Important!

Fred wants to keep you and your family safe but we need you to do your bit. Read this instruction carefully before mounting and using this device. The child protective function of the device may be affected if you do not follow the instructions. Keep the instructions for future reference. This product does not re-engage automatically. Manually replace the block to secure your cupboard/ appliance after use.

Step by step video fitting guides at
www.fredsafety.co.uk

Recommended Usage

Use on cupboards and appliances with double doors 6-21mm thick. If the cupboard has a central partition behind the 2 doors, this should be 15mm or wider. If there is no central partition, the underside of the cupboard needs to be a flat surface.

Step by step installation guide

1



Fred adhesive is instantly strong and can only be positioned once, so first practice each fitting step **WITHOUT** exposing the adhesive. Before installation, clean and dry the surface with a 50:50 solution of water plus white vinegar or surgical spirit.

2



Remove the protective layer to expose the adhesive strip on the EZ-Dock™ (H) and stick it out of your child's reach where you wish to store the Block. Push firmly into place for 30 seconds then leave for 24 hours before use.

Option A:

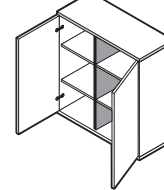

Option B:

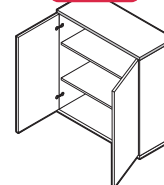

Option A:

Where the cabinet has a vertical partition behind the doors

3 A

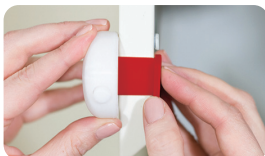

Attach the Block (A) to each of the Locking Tabs (C-F) in turn, and choose the fitting combination that fits most snugly around the thickness of the door. The Locking Tabs slide into the back of the Block and are attached/released by squeezing the two buttons on the Block together.

4 A



Slide the preferred Locking Tab through the Mounting Plate (G) and then attach the Block.

5 A



Hold the assembled unit around the thickness of one door, with the Block facing towards you. Check that in this position, the door can still close properly.

Option B:

Where the cabinet is open with no partition behind the doors

6 A



Remove the protective layer to expose the adhesive on the Mounting Plate, and close the door firmly for 30 seconds. Remove the Block, so that both doors can be closed, and leave for 24 hours before first use.

3 B



Attach the Block (A) to the Top Fix Locking Tab (B). The Locking Tab slides into the back of the Block and is attached/released by squeezing the two buttons on the Block together.

4 B



Hold the assembled Block and Locking Tab around the thickness of one of the doors, with the Block facing towards you, pushed against the front of the cupboard door, and the adhesive of the Locking Tab facing up.

5 B



Remove the protective layer to expose the adhesive on the Locking Tab. Shut the door and slide the Block up until the Locking Tab adheres to the top of the cabinet.

6 B



Remove the Block, open the door, and push the Locking Tab firmly into place for 30 seconds. Both doors can then be closed, and the Block left for 24 hours before first use.

1 To open and close



Squeeze the 2 buttons on the Block together, and pull the Block gently towards you. Once the Block has been removed, the doors can be opened and closed as usual. To reattach the Block, reverse these actions.

2

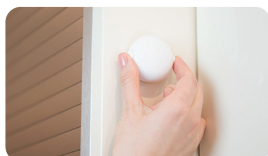

Lock the Block onto the EZ-Dock™ when not in use. The locking tab remains visible as a reminder that the doors are unlocked.

To permanently remove



Use a blunt knife to carefully prise away the Tab from the surface, and rub away any residual adhesive with your fingers.

Important: Make sure that the child cannot reach inside the cupboard - the opening gap of the doors when the block is engaged must not exceed 30mm.

Once removed, the product is not suitable for re-use and should be disposed of safely.

⚠ Safety Warnings

- **WARNING** - This locking device restricts access by young children to the contents of a cupboard or drawer but cannot ensure absolute child safety.
- This product can offer protection for children up to 24 months, but some may be able to open it considerably earlier.
- When your child learns how to use the block, it provides no protection and should no longer be used.
- **ATTENTION!** This product acts as a deterrent but cannot replace adult supervision. Never leave children unattended. This is not a toy, do not leave the removable parts where they are accessible to young children.
- Check the product regularly to ensure it is safe to use and working correctly.
- **WARNING** - Replace the device if any part is broken, torn or missing.
- Not suitable for use on high heat-generating appliances (e.g. ovens, microwaves).
- Designed for single installation, cannot be repositioned.

Other Important Information

- **Care instructions:** Wipe with a damp cloth. Do not immerse this product in water.
- **Caution!** Fred adhesives may cause damage to some surfaces. We accept no liability or responsibility for damage or defects arising from the use of the adhesive on any furniture or surfaces. This product is most suitable for cabinets made of solid material e.g. wood. If the surface of the cabinet is laminated, the adhesive attaching the laminate to the inner material (usually mdf or chipboard) may not be strong enough to withstand a strong tug on the Block by a child. If this is the case, you will need to use 12mm and 15mm screws (not supplied) to install this product.
- Occasionally, you will need to use a 50:50 mix of water plus either white vinegar or surgical spirit to remove adhesive residue. This mix could cause damage to some surfaces, so please test its use on a discreet area first. We do not accept any liability for damage so caused.
- Claims against warranties or guarantees must be arranged through your retailer, seller or trader. Proof of original purchase is required.

Making homes safer with Fred...



Corner Protector



Anti-Skid Tape



Invisible Magnet Lock



Furniture Anti-Tip Kit



Stove & Hob Guard



Stairgates

We can help you more at www.fredsafety.co.uk

FRDD. Important! Effective when used in accordance with these instructions. Only for use indoors in the domestic environment. Complies with BS EN16948:2017. Fred® is a registered trademark of its distributor Cheeky Rascals Ltd, Liss Mill, Mill Road, GU33 7BD, UK help@cheekyrascals.co.uk. Design and manufacturing by Safe and Care Co. ApS, Sellerup Vangvej 32, DK-7080 Børkop, Denmark. Registered Design. Made in China.