

Ziza™ Seat

Art. No. SC600

User Manual

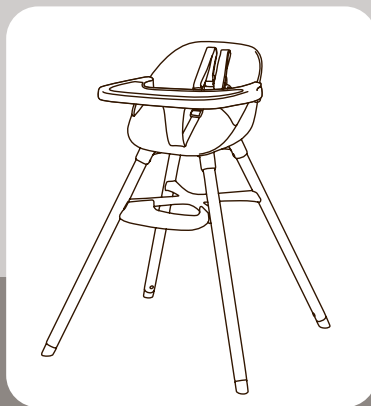

Ziza™
A SAFE CHOICE

IMPORTANT! READ CAREFULLY AND KEEP FOR FUTURE REFERENCE

SAFETY WARNINGS

- WARNING! Never leave the child unattended.
- Always use the restraint system.
- Falling hazard: Prevent your child from climbing on the product.
- Do not use the product unless all components are correctly fitted and adjusted.
- Be aware of the risk of open fires and other sources of strong heat in the vicinity of the product.
- Be aware of the risk of tilting when your child can push its feet against a table or any other structure.
- Always keep small parts away from children.

Other important information

- Caution! This article has been developed for the benefit of your children. It is not a toy and is not a substitute for supervision by adults.
- Do not use the product until your child can sit up unaided.
- This product is intended for children able to sit up unaided and up to 3 years or a maximum weight of 15 kg.
- Do not use the product if any part is broken, torn or missing.
- Use the product only for the intended purpose.
- This safety product is only suitable for domestic indoor use.
- Always use this product on a flat and rigid floor.
- Complies with EN 14988:2017+A1:2020 & REACH.
- Check the product regularly to ensure it is safe to use and working correctly. All screw fittings should be tightened properly, regularly checked and re-tightened if necessary.
- Care instructions: All parts of the Seat can be wiped clean with a damp cloth using a mild detergent. The Tray is dishwasher safe on a medium cycle or can be handwashed and immersed in water. The Tray should be placed on the top shelf of the dishwasher. Some detergents are abrasive and may discolour the Tray. This will affect its appearance, but not its performance.

What's included

1 Seat

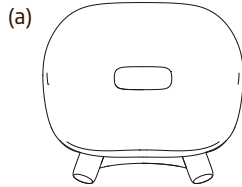

4 Legs

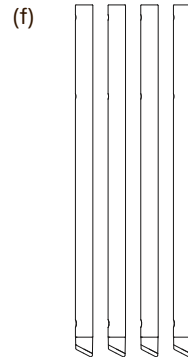

1 Foot Rest*



1 Cross Support

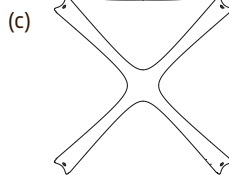

1 Tray



1 Brace

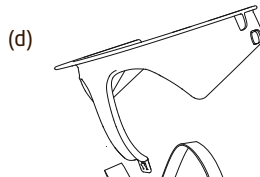

2 Small screws

(h)  x 2

8 Large screws

(i)  x 8

1 Allen Key

(j) 

1 Harness
- premounted

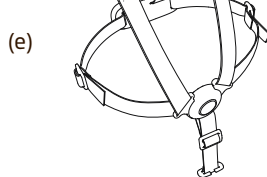

Please note: You will need a Phillips screwdriver.

*The Footrest is pre-mounted on the Cross Support with the 2 Small screws (h).

Mounting the legs

Insert one of the legs (f) into the seat (a). Make sure that the upper hole in the leg is located exactly behind the hole in the seat. Insert one of the Large screws (i) ensuring that the screw passes through both the hole in the seat and the hole in the leg. Tighten with the Allen Key (j). Repeat the procedure for all four legs - see fig. 1.

Fig. 1

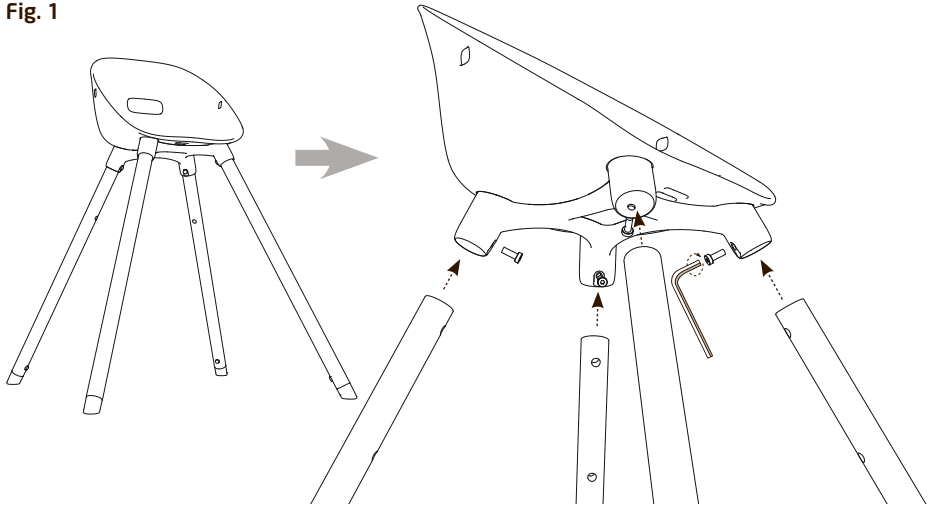

Mounting the Cross Support

Place the Cross Support (c) underneath the seat as shown at Fig. 2a making sure that the holes in the Cross Support turn towards the front . Fasten by using the 4 remaining Large screws (i) and tighten with the Allen Key - see fig. 2b.

Please note: Fig. 2a and 2b depict the Cross Support without the Foot Rest although this may be premounted.

Fig. 2a

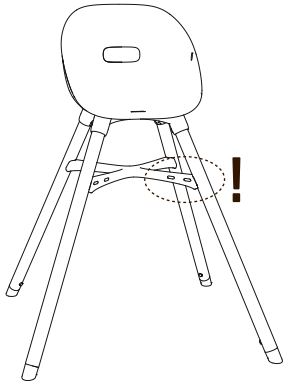
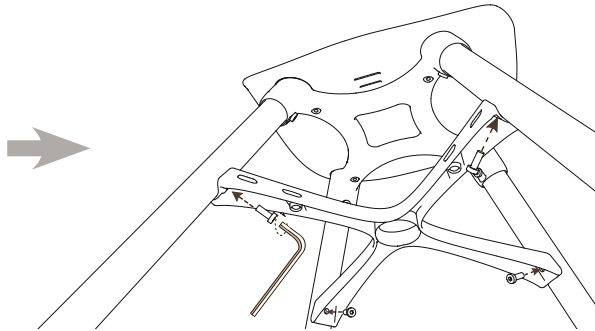

Fig. 2b



Changing the position of the Foot Rest

The Foot Rest can be mounted in two positions depending on the height of the child - see Fig. 3a (upper position) and 3b (lower position).

The Foot Rest is mounted on delivery of the product, but this can be changed by removing the two Small screws (h) with a Phillips screwdriver, flipping the Foot Rest and re-attaching with the screws - see fig. 3c and 3d.

Fig. 3a

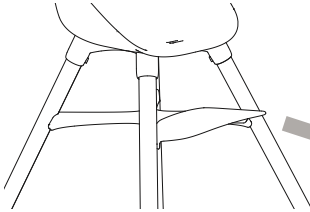

Fig. 3c

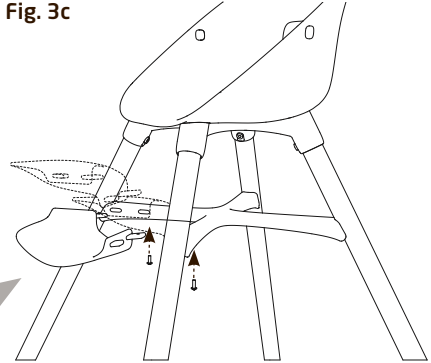

Fig. 3b

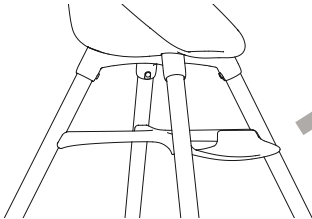
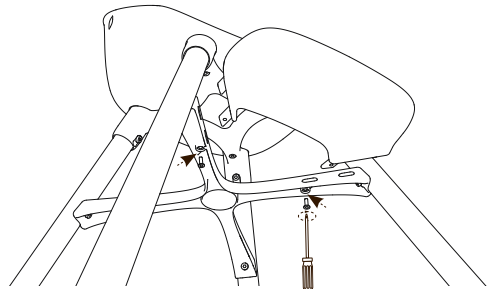

Fig. 3d



Mounting the Brace

First, click the Brace (d) onto the front of the Seat (the slot closest to the front) and then to both sides - see fig. 4a and 4b.

Fig. 4

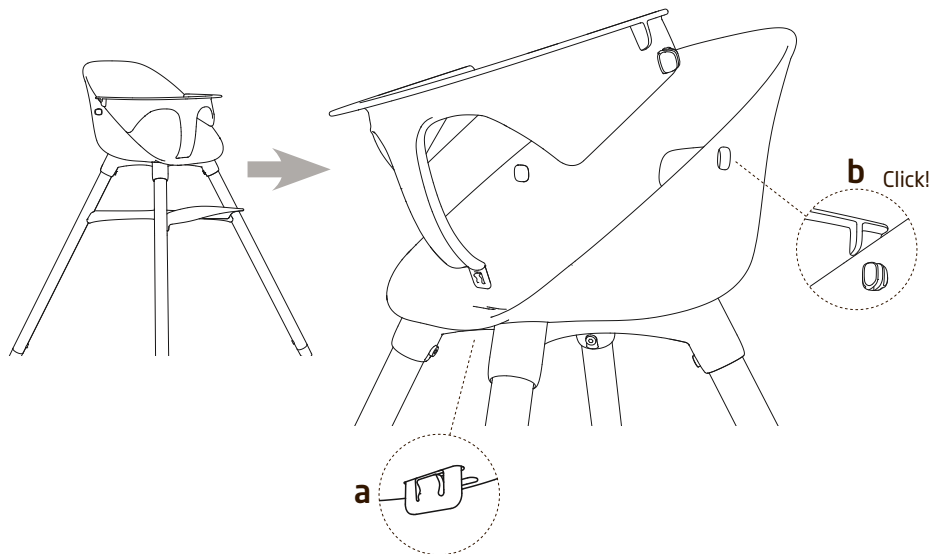

Removing and remounting the Harness

The Harness (e) is mounted on delivery of the product, but you may wish to remove the Harness temporarily for cleaning. This is how to remount the Harness (removal requires the same steps but in reverse order):

Pull the Harness through the large slot in the seat from the back to the front. Continue until the back plate clicks into position - see fig. 5a and 5b.

Fig. 5

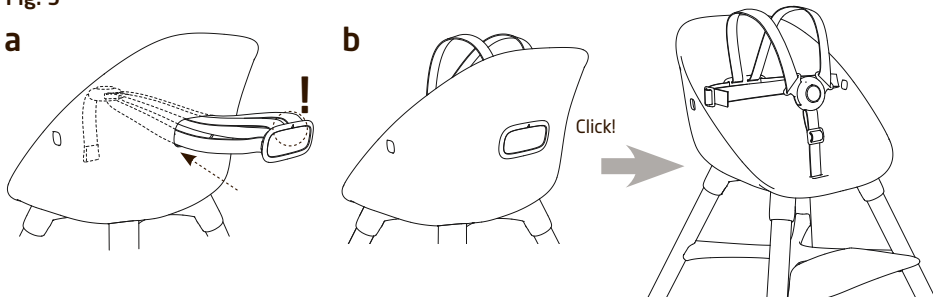

Pull the strap through the inner slot in the seat (the outer slot, closest to the front, is for mounting the Brace) - see fig. 6a, and attach the buckle as shown in fig. 6b.

Fig. 6

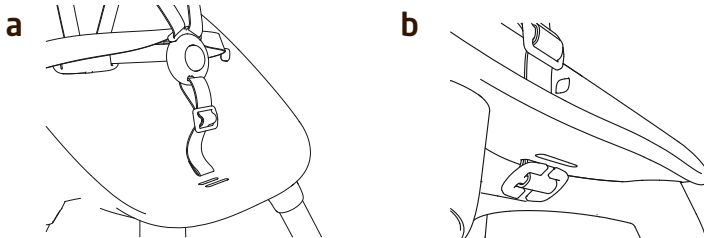

Mounting the tray

Using the tray (g) requires that the Brace is also fitted. Then the tray is easily mounted by simply sliding it along the Brace and pushing until it clicks on - see fig. 7a and 7b.

Removing the tray is done by dragging outwards on both sides where the tray is clicked on (fig. 7c) and then pulling towards the front - see fig. 7d.

Fig. 7

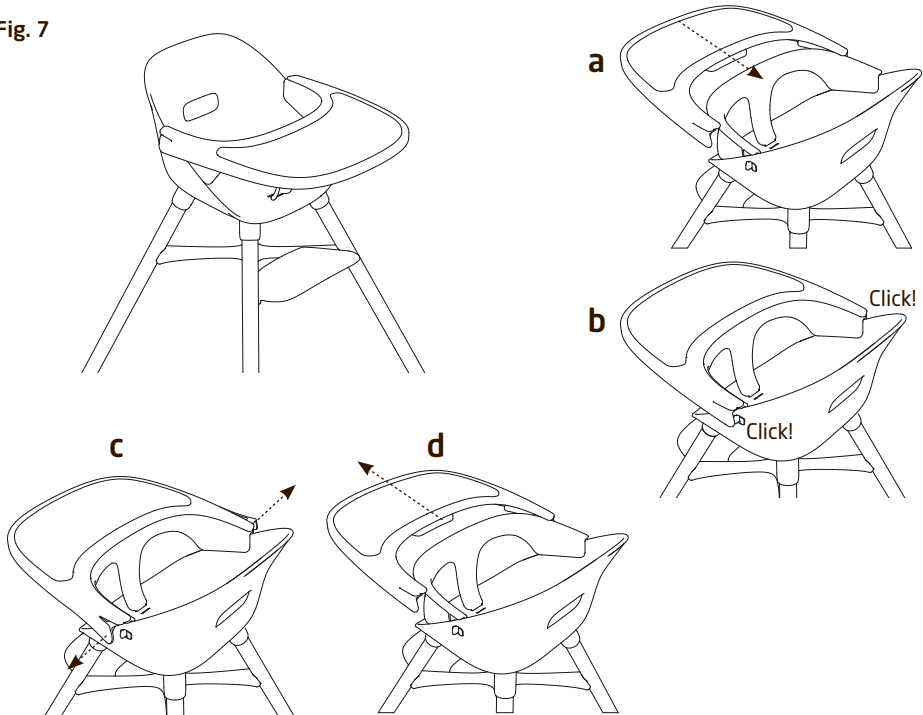



For over 70 years, the Safe and Care Co. has dedicated itself to finding ways of reducing the hazards to toddlers found in every home. Our products are not substitutes for parental care and supervision; our aim is to give parents peace of mind by designing products that improve child safety, then manufacture them to strict quality requirements from the best materials available.



www.safeandcareco.com

Made in China

Ziza™ is a high quality brand developed and manufactured by Safe and Care Co.

Marketing, Europe: Safe and Care Co. ApS, Hustedvej 3, DK-7830 Vinderup, Denmark

United Kingdom: Cheeky Rascals Ltd, Liss Mill, Mill Road, Liss, GU33 7BD
www.zizakids.co.uk

Asia: Manufacturing: Safe and Care Co. | Jiangbei Road, Xiani Village | 523655 Qingxi Town
Dongguan City | Guangdong Province | China

20211012-V1