

## Coner mount hinge side replacement

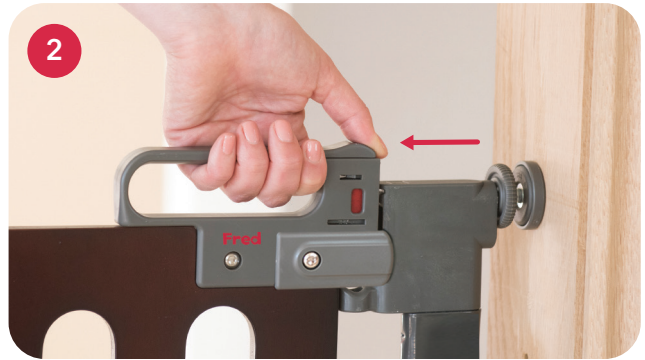

Undo the Tensioning Wheels and the Nuts, so that the Spindles come away from the Wall Nuts. The Gate can be removed leaving just the Wall Cups in position. To reinstall the Gate, follow the instructions from **Step 12** above.



To open the Gate, holding the handle, use your thumb to slide the locking catch on the top of the Gate Panel back towards the handle, and simultaneously lift the Gate to swing it open. The window in the handle will show red when the Gate is open.



Undo the screw fixing the hinge tube.



Pull out the hinge tube and need hold the Acrylic Panel at same time.

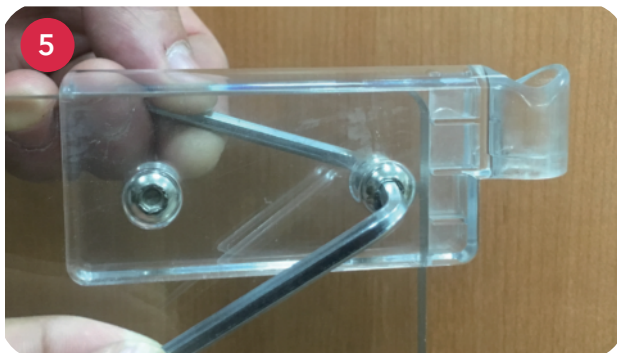

Undo the screw fixing the hinge tube and take off the corner mount. Sliding the new mount on the acrylic panel and lining up the holes. Then use the two allen key to bolt it securely.



Slide the hinge tube into the holes of the corner mounts and hinges.

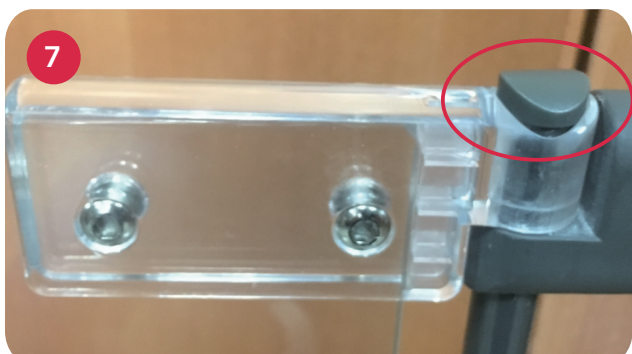

Adjust the tube to make the top plug as picture and flat with the corner mount.



Use screw- driver screwing the hinge tube securely.