

Coner mount hinge side replacement

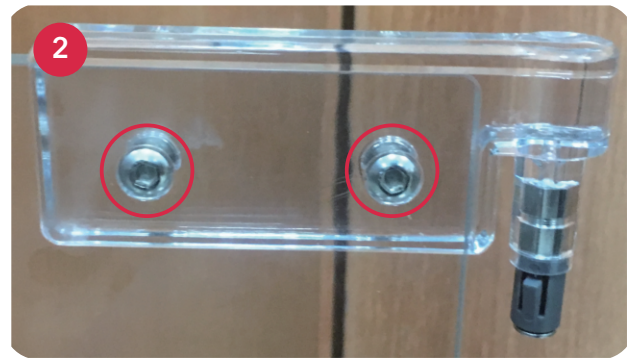

Push the Removal Tool (T) up underneath the top hinge, and lift the Gate vertically.



Use both Allen Keys to remove the both bolts and take off corner mount hinge side.

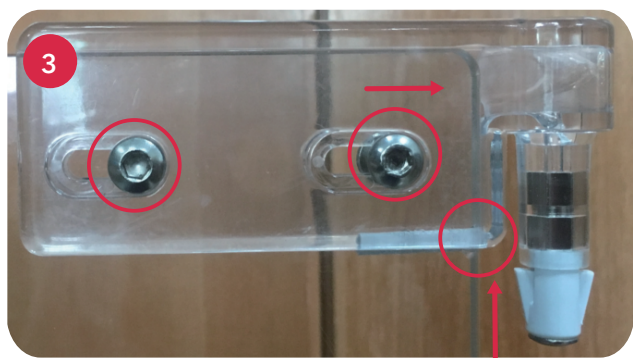

Sliding the the corner mount into Acrylic Panel and lining up the holes. Then use two Allen Keys to bolt it altogether securely.

IMPORTANT: Make sure mount slot right side is lining up with Acrylic Panel holes and no finger Trap gap between corner mount and Acrylic Panel.



To replace the Gate, simply drop the 2 locator pins of the Gate Panel back onto the Hinge Rail ensuring that it '**clicks**' securely back into place.